

# BL ONE Select DUAL-S 1300 >90

BL ONE Select Dual-S LED strip 1300lm/m 24VDC 12.6W/m IP20 940 5.04m

Article no.: 100075

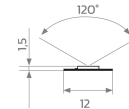
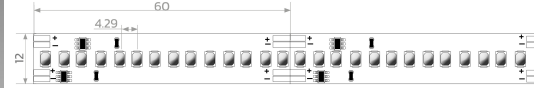
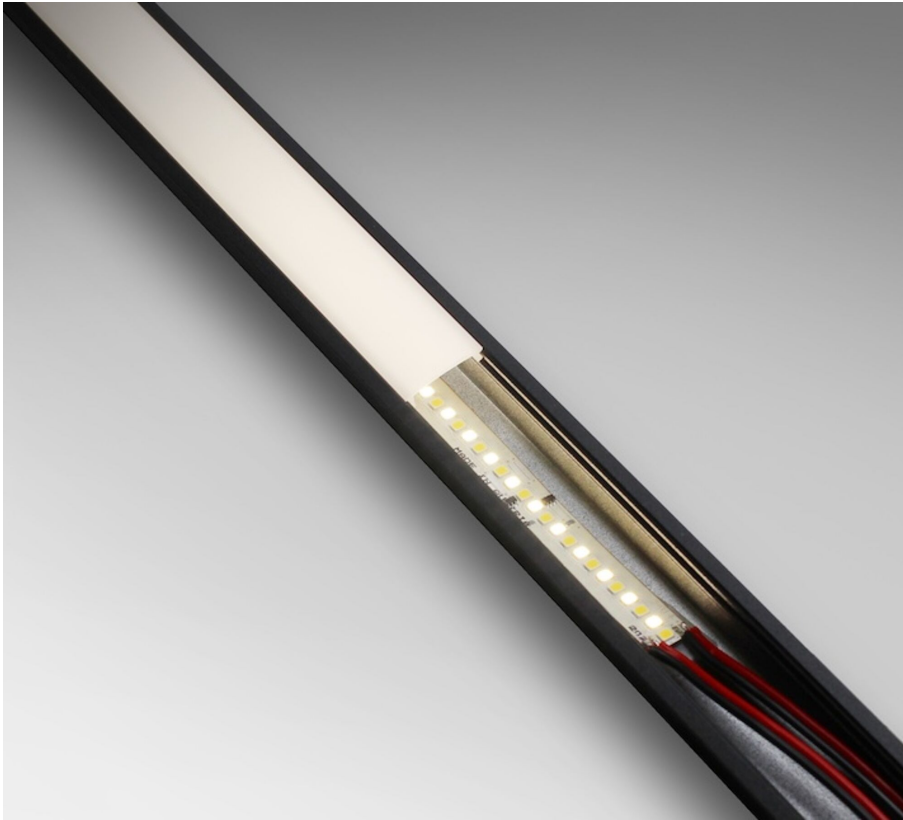

Lamp voltage



Max. length



Colour rendering index CRI



Luminous flux per meter

## TENDER TEXT

LED strip ONE Select Dual Safety 1300 lm/m 24VDC 12.6W/m 103lm/W IP20 CRI>90 4000K WHITE, two independent contacts, 2x connection cable 500 mm on each side, 5.04 metres LED module BL ONE Select DUAL-S 1300 >90 Article 100075 Linear LED light strip on a flexible circuit board. Installation using self-adhesive heat-conducting adhesive tape. Dimmable using BILTON LEDON Technology LED dimmer. Suitable for ambient temperatures from -20 ... +45 at a service life of 60000 . The BL ONE Select DUAL-S 1300 >90 LED-strip has a luminous flux of 1300 at 12.6 , resulting in an efficiency of 103 . At a nominal voltage of 24 DC on the connection, a maximum module length of 6500 can be achieved. In terms of lighting, the module has a colour temperature of 4000 K and a beam angle of 120 . All this with a colour rendering index of >90 and a Binning selection based on SDCM3 (MacAdams). The light strip can be separated every 60 , resulting in a LED distance of 4.29 . Degree of protection IP20 Dimension (L x W x H): 5040 x 12 x 1.5

## TOP-FEATURES

//\_\_ Doubles the life cycle thanks to double and independent LED channels

//\_\_ doubles the life of 60000

//\_\_ Developed and produced in Austria by BILTON LEDON



# BL ONE Select DUAL-S 1300 >90

BL ONE Select Dual-S LED strip 1300lm/m 24VDC 12.6W/m IP20 940 5.04m

Article no.: 100075



## MECHANICAL DATA

Width	12
Length	5040
Height/depth	1.5
Model	Band
Self-adhesive	yes
Lamp type	LED nicht austauschbar
Distance	4.29
Distance relating to	LED zu LED
Degree of protection (IP)	IP20
Length of particular segments	60
Lowest bending radius	20
Number of lamps per meter	233

## ELECTRICAL DATA

Protection class	III
Voltage type	DC
Lamp voltage	24
Input voltage range	23 - 25
Lamp power per meter	12.6
Overall efficiency	103

## LIGHT TECHNICAL DATA

Beam angle	120
Colour rendering index CRI	>90
Colour temperature [K]	4000
Colour of light	White
Luminous flux per meter	1300
Energy efficiency class of the built-in lamp	F
Colour consistency (McAdam ellipse)	SDCM3

## CONNECTION

Conductor cross section	0.5
Number of poles	2
Max. length	6500

## TEMPERATURE TECHNICAL DATA

Ambient temperature during operating	- 20 ... + 45
Rated life time L70/B10 at 25 °C	60000

# PACKAGING INFORMATION

## BL ONE Select DUAL-S 1300 >90

State of origin AT  
**BL ONE Select Dual-S LED strip 1300lm/m 24VDC 12.6W/m IP20 940 5.04m**  
Customs tariff number 94054099  
Article no.: 100075



Gross width [mm]	200
Gross height [mm]	22
Gross length [mm]	200
Net width [mm]	12
Net height [mm]	1.5
Net length [mm]	5040

\* Information about the electrical and lighting technology measurements: Performance data measured after 1 min. at 25 °C ambient temperature and a light colour of 4,000 K (or RGB). These values can have a tolerance value of -/+ 10% (or -/+ 15 %at ECO / TWO / RGB / AIR ). Module length at 24 V input voltage at the module and luminous flux drop 10% over the specified length.

SAFETY INFORMATION: Read the safety and installation instructions carefully and completely before commissioning. The operating instructions can be found at: [www.better-light.at](http://www.better-light.at)

DISCLAIMER OF WARRANTY: The technical information corresponds to the status at the time of printing and have been worked out to the best of our knowledge. However, errors and printing errors are reserved. Make sure that you always use the latest version of the data sheets. The latest data sheet can be found at: [www.better-light.at](http://www.better-light.at)